



# AutoFil GenII

## PARTS CATALOG

**We keep the world rolling.**  
No flats, smoother ride, more protection.

**TyrFil**™  
A **CARLISLE** BRAND

**353231  
Aluminum Fill Gun**

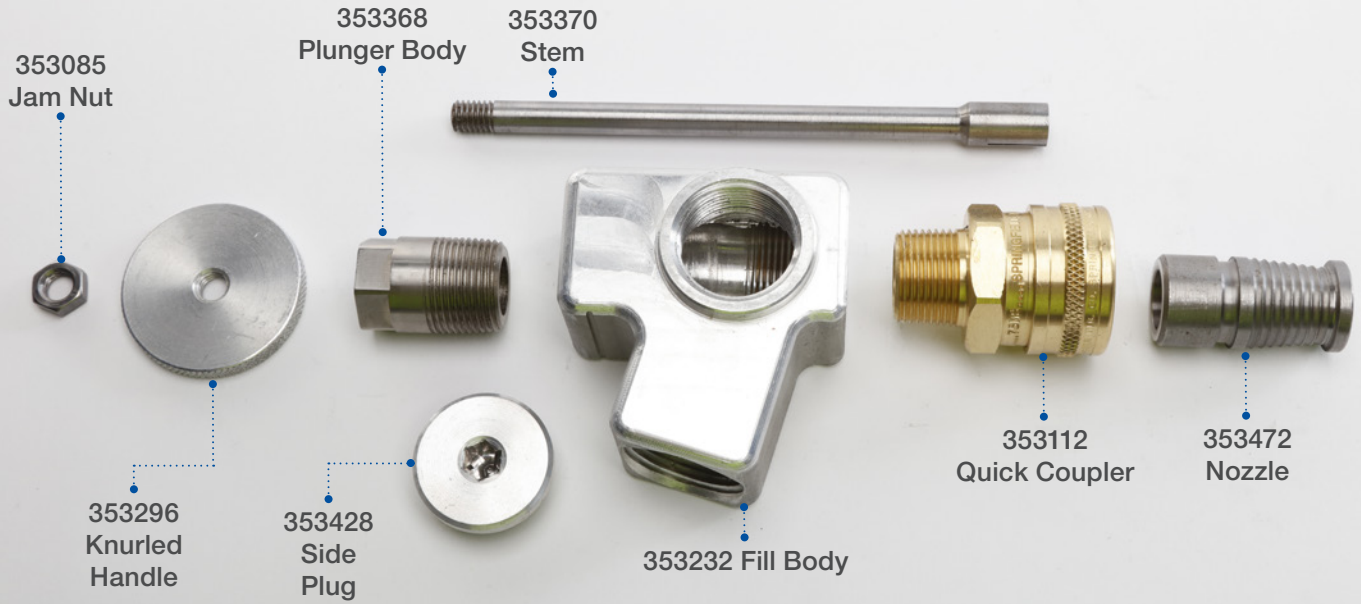

**Fill Needles and Bullets**



**341829  
Injector Assembly**

353270  
Hex Bushing  
1 1/4" x 1"

341822  
Hex Bushing  
1 1/4" x 3/4"

353399 Reducer  
2 1/2" to 1 1/4"

353451  
Tee 1 1/4"

**341828  
Drain Assembly**

353073  
3/4" Elbow

353050  
Ball Valve

353056  
3/4" Hex Nipple



353291  
Injector Screw



353524  
Barrel



353235  
Gauge Assembly



353464  
Supply Hose



341827  
Fluffer Bar



353407  
Grinder Screen



353419  
Safety Switch



Pressure  
Sensor and Cable  
353376 - Sensor  
353465 - Cable



353199  
Crumb Sensor



Extended  
Stem and Nozzle  
353226 - Stem  
353225 - Nozzle



353243  
Foot Pedal

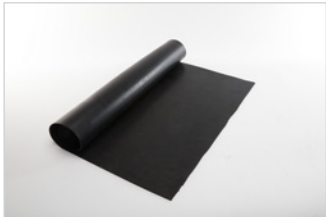

341821  
Rubber Hopper Cover



353477  
Gear Pump



353150  
Bearing Housing



341823  
Pillow Block Bearing



352946  
Kamlock



353220  
End Cap



353077  
Whip Hose



353521  
Breaker Bar



353253  
Auger Bearing



353443  
Stator Pin



353153  
Bearing Sleeve



341824  
On-Off Switch



353475  
Check Valve



353459  
Shaft Bearing



353192  
Coupler



341818  
Belt



353107  
1" Fill Hose



353114  
3/4-inch Hose with  
Swivel (high pressure)



353197  
Coupler Insert



**3/4" Manifold pictured. 1/2" Manifold part numbers are also included.**

Item	Part Number	Description	Designation
<b>A</b>	353007	1/4" Quick Connect	Fits both 1/2" & 3/4"
<b>B</b>	352999	1/4" Ball Valve	Fits both 1/2" & 3/4"
<b>C</b>	353001	1/4" Close Nipple	Fits both 1/2" & 3/4"
<b>D</b>	352996	1/4" Fluid Coupler	Fits both 1/2" & 3/4"
<b>E</b>	353054 (3/4") 353229 (1/2")	Quick Connect Female	3/4" & 1/2" Part Numbers
<b>F</b>	352983 (1/2")	Quick Connect O-Ring	Fits 1/2" Manifold Only
<b>G</b>	353062 (3/4")	Quick Connect O-Ring	Fits 3/4" Manifold Only
<b>H</b>	353059 (3/4") 353315 (1/2")	Quick Connect Male	3/4" & 1/2" Part Numbers
<b>I</b>	353069 (3/4") 353139 (1/2")	Spacer Bar	3/4" & 1/2" Part Numbers
<b>J</b>	353050 (3/4") 353080 (3/8")	Ball Valve	3/4" & 1/2" Part Numbers
<b>K</b>	353061 (3/4") 353221 (3/8")	Black Handle	3/4" & 1/2" Part Numbers
<b>L</b>	353355 (3/4") 352984 (1/2")	Mixing Coupler	3/4" & 1/2" Part Numbers
<b>M</b>	353066 (3/4") 353138 (1/2")	Manifold Block	3/4" & 1/2" Part Numbers

Visit [www.CarlisleTyrFil.com](http://www.CarlisleTyrFil.com) for specs, weight charts, and more!

**We keep the world rolling.**  
No flats, smoother ride, more protection.

**Carlisle TyrFil**  
140 Sheldon Road, Berea, OH 44017 | (800) 821-4147 | [www.CarlisleTyrFil.com](http://www.CarlisleTyrFil.com)

