

½" 612002

TyrFil Flushless Pump
with Manifold (¾"
612001 also available)

• 353279



TyrFil Flushless Pump

PARTS CATALOG

We keep the world rolling.
No flats, smoother ride, more protection.

TyrFil™
A **CARLISLE** BRAND



3/4" Manifold pictured. 1/2" Manifold part numbers are also included.

Item	Part Number	Description	Designation
A	353007	1/4" Quick Connect	Fits both 1/2" & 3/4"
B	352999	1/4" Ball Valve	Fits both 1/2" & 3/4"
C	353001	1/4" Close Nipple	Fits both 1/2" & 3/4"
D	352996	1/4" Fluid Coupler	Fits both 1/2" & 3/4"
E	353054 (3/4") 353229 (1/2")	Quick Connect Female	3/4" & 1/2" Part Numbers
F	352983 (1/2")	Quick Connect O-Ring	Fits 1/2" Manifold Only
G	353062 (3/4")	Quick Connect O-Ring	Fits 3/4" Manifold Only
H	353059 (3/4") 353315 (1/2")	Quick Connect Male	3/4" & 1/2" Part Numbers
I	353069 (3/4") 353139 (1/2")	Spacer Bar	3/4" & 1/2" Part Numbers
J	353050 (3/4") 353080 (3/8")	Ball Valve	3/4" & 1/2" Part Numbers
K	353061 (3/4") 353221 (3/8")	Black Handle	3/4" & 1/2" Part Numbers
L	353355 (3/4") 352984 (1/2")	Mixing Coupler	3/4" & 1/2" Part Numbers
M	353066 (3/4") 353138 (1/2")	Manifold Block	3/4" & 1/2" Part Numbers

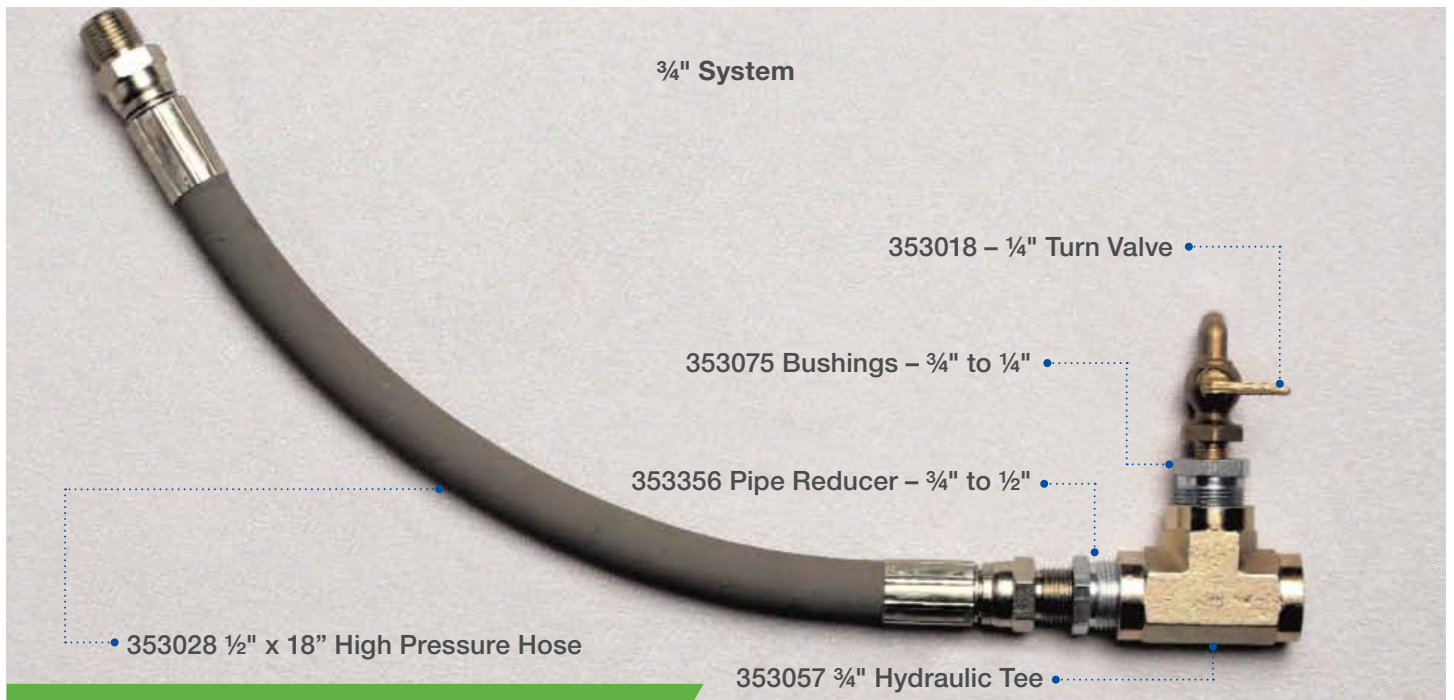
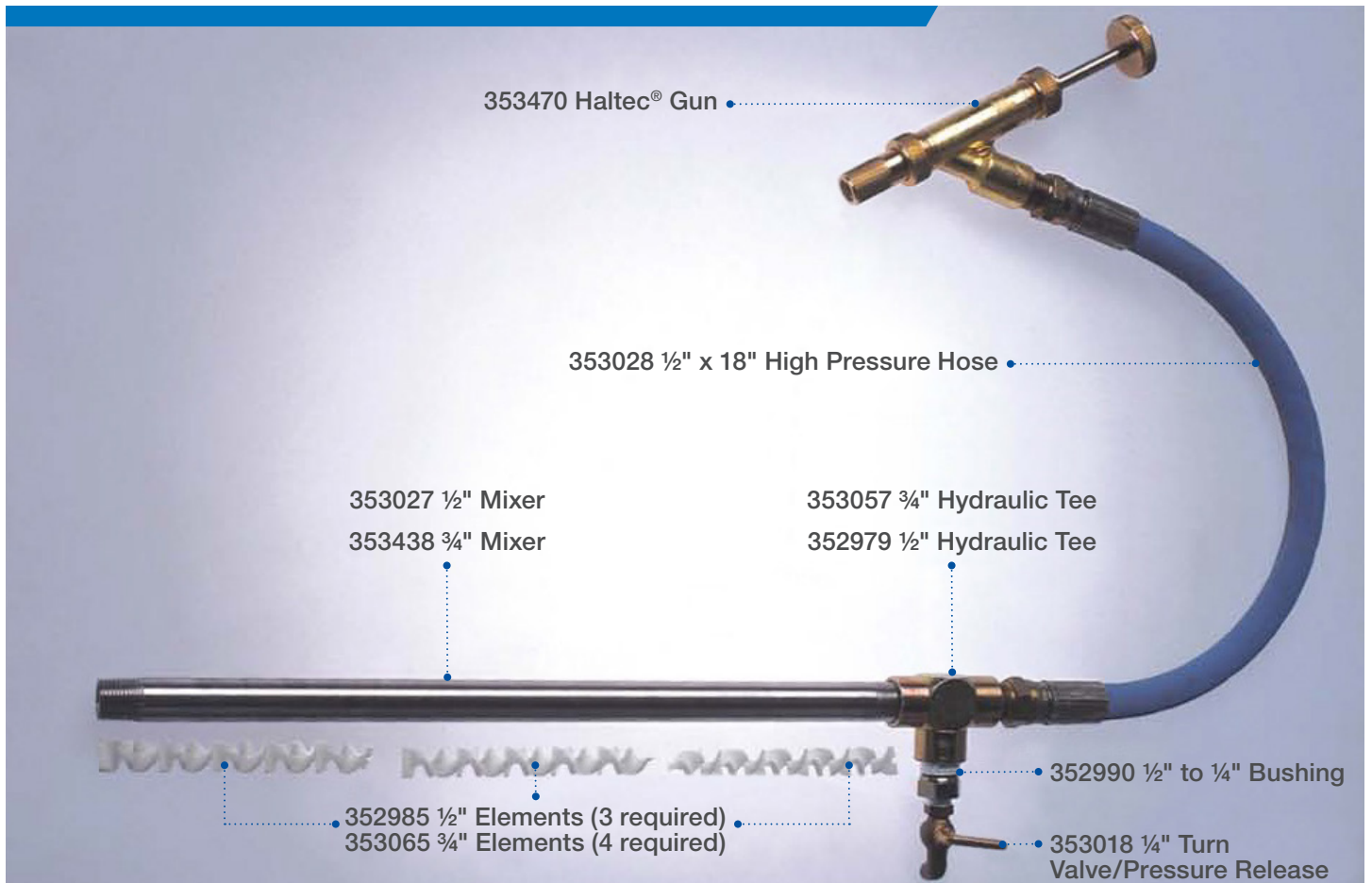

353470
Haltec® Valve Adapter Gun and Core Ejector

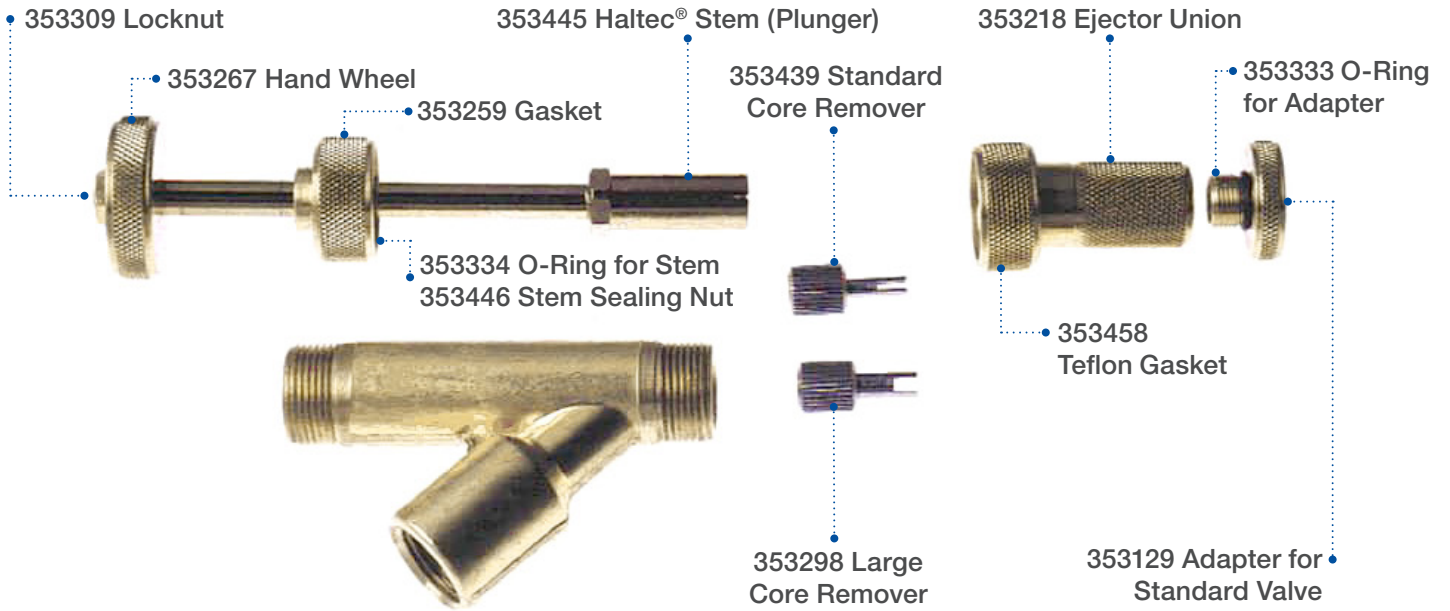

612417
Rebuilt Air Motor



612416
Rebuilt Lower Cylinder

353328

353305

352999

353171

353230

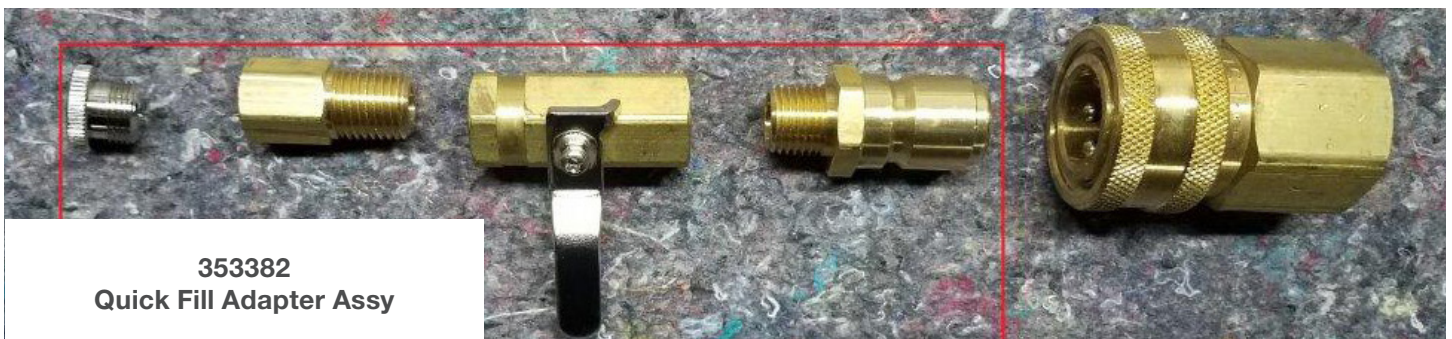

353382
Quick Fill Adapter Assy



353209
Hypodermic Needles 12GA X 2"



353211
Hypodermic Needles 14GA X 1 1/2"



353210
Hypodermic Needles 12GA X 3"



353424
Air Motor Seal Kit



353425
Lower Cylinder Seal Kit



352944
Dust Plug



352941
Gauge 0-300 psi



353433
Gauge 0-1000 psi



352981
Lubricator 1/2"



352956
Oil TSL Lower Pump – pint



353329
Needle Inserter



353463
Tote Connector



352945
Kamlock (female) 1 1/2"



353295
King Combo Kamlock 1 1/2"



6ft - 353107
8ft - 352954
1" Hose



353135
Sidewall Injector Needle (small)

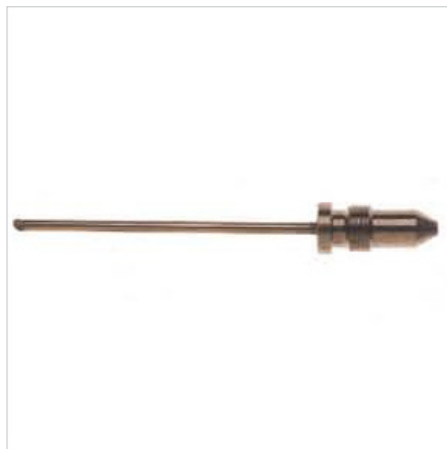

353136
Sidewall Injector Needle (medium)



353137
Sidewall Injector Needle (large)



353133 Air Regulator
353134 Air Regulator with Gauge



353113 - 1/2" 353114 - 3/4"
Hose with Swivel (high pressure)



353476
Water Separator



353204
Desiccant Cartridge



353206
Desiccant Holder



353448 Stroke Counter
353449 Arm
353450 Plate



353435
Spanner Wrench



352989 1/2" Wire Brush
353074 3/4" Wire Brush
353063 1/2" Nylon Brush
352952 3/4" Nylon Brush



353125
Accessory Cleaning Brush

Visit www.CarlisleTyrFil.com for specs, weight charts, and more!

We keep the world rolling.
No flats, smoother ride, more protection.

Carlisle TyrFil
140 Sheldon Road, Berea, OH 44017 | (800) 821-4147 | www.CarlisleTyrFil.com

07.08.22 © 2022 Carlisle.
TFS-13147 - "TyrFil Flushless Pump Parts Catalog"



Carlisle is a trademark of Carlisle. TyrFil is a registered trademark.
Haltec® is a registered trademark of the Haltec Corporation.