

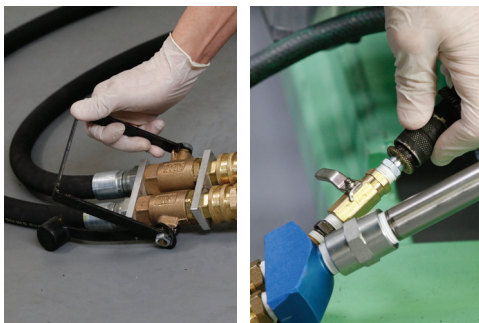

1) Begin by pressing the emergency stop button.



2) Put the manifold handle in the closed position. Next, hook up an air hose to the manifold.



3) Then place the fill hose into a waste container.

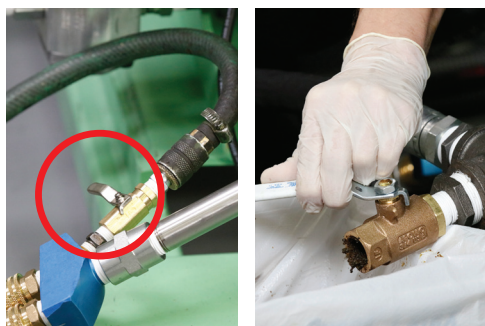

4) Slowly open the gauge ball valve on the manifold to blow mixed TyrFil material from the mixing tube, barrel, fill hose and fill gun.

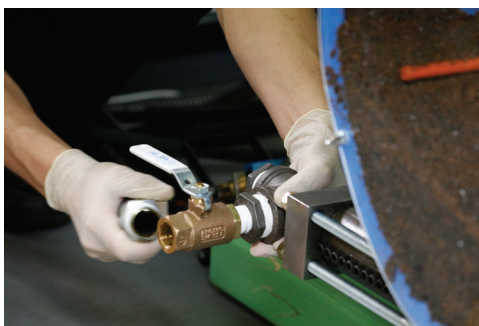

5) Remove the fill hose from the sample valve and allow it to drain into a suitable container.



6) Remove the sample valve from the injection barrel.



7) Next, release the emergency stop on the control panel. Run only the grind and injector until you have dry material exiting the barrel. Then press the emergency stop and turn the machine off at the main power source.



8) Thoroughly clean the sample valve with a brush and store in alcohol.



9) Remove the PSI gauge from the gun assembly. Clean the diaphragm thoroughly with a brush in 99% isopropyl alcohol. Store in a safe place.



10) Clean the fill gun plunger and the gun body, rinse and store all parts in alcohol.



11) To clean the fill hose, put a cap on one end and fill with alcohol. Next put a cap on the other end of the hose.

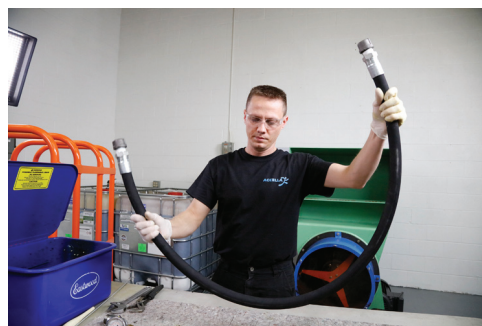

12) With a cleaning motion, move the hose back and forth to agitate the alcohol inside. After a minute of agitation, remove one of the capped ends and drain the hose. Then refill the hose a 2nd time with alcohol. Replace the cap and store in a safe place for future use.



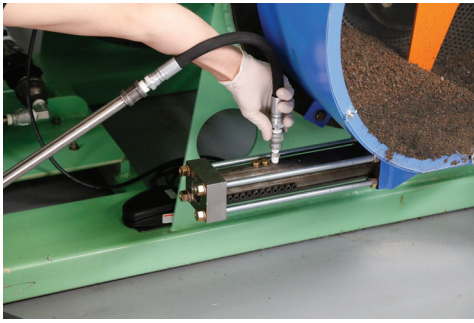

13) Remove the I/C delivery whip hose from the injection barrel.



14) Disconnect the mixing tube from the manifold head, leaving the coupler on the head.

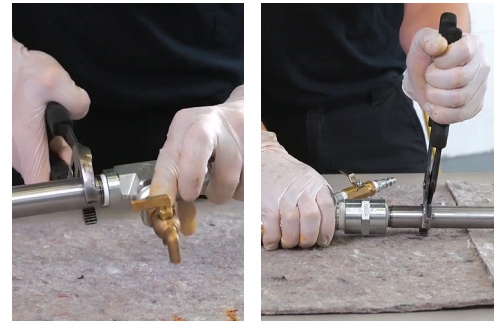

15) Remove the whip hose from the mixing tube, then disconnect the mixing tube from the manifold head, leaving the coupler on the head.



16) With the ejection rod, remove the mixing elements from the tube.



17) Lay the whip hose in solvent and clean the sample drain valve with a brush. Make sure the sample drain valve is open.



18) Clean the mixing tube and store in solvent.



19) Clean the mixing elements in the solvent and store them in a safe place to avoid breakage.



20) Open the manifold head pressure gauge valve and clean the manifold head connectors. Store the manifold head in the solvent.



21) Clean the gun stem connector and store in solvent.

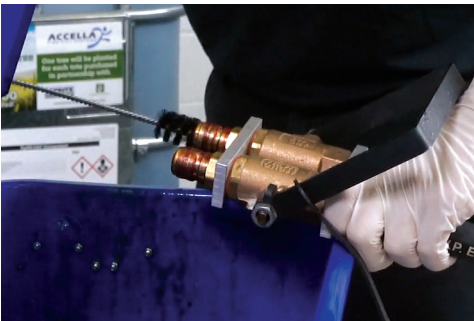

22) Thoroughly clean the I/C hand check valve using a brush to clean the inside of the connectors.



23) Grease the ISO-side connector and cover with a cap.



24) Shut off both tote valves and turn off at the main power source.

*You have successfully shut down & cleaned the AutoFil Recycler System! These important steps will allow you to be prepared and ready for the next time you fill a tire.*

*Please keep your manual handy so you will have access to more detailed information about safety, tire filling and troubleshooting.*